

# ROD-LATCH SYSTEM

## SWINGHANDLE GEAR BOX

502

ALL IN METAL



IP 65



LH/RH



RoHS

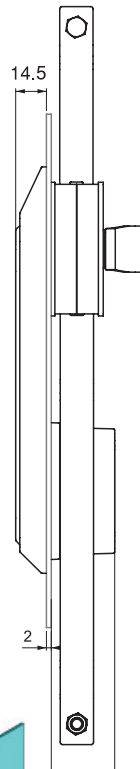
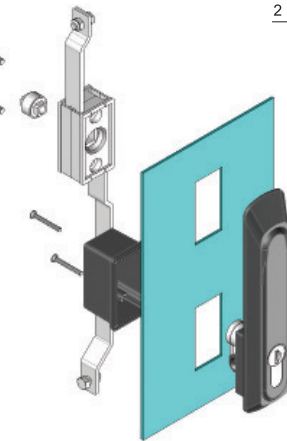
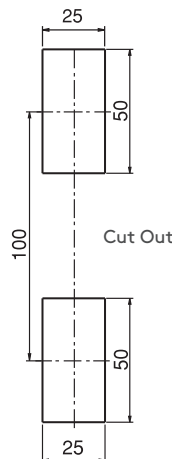

25.5: Zamak cylinder  
32: Brass cylinder

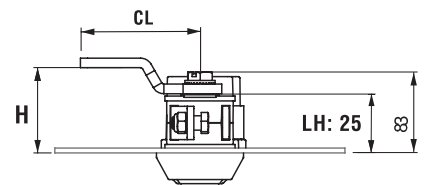
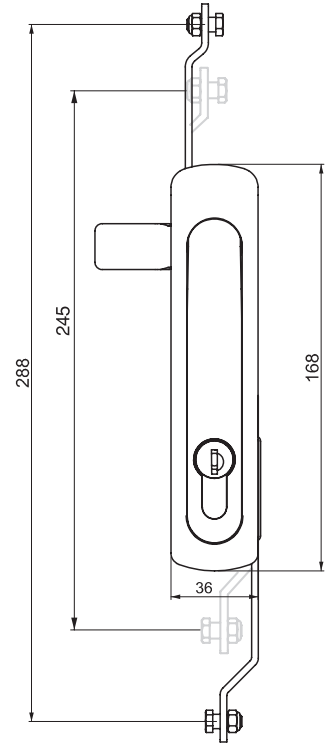

- Stainless steel version: page 424
- Die-cast construction stronger than polyamide
- Thin external profile, 14.4 mm, for flush appearance
- High-security, brass, Euro Profile single-cylinder available
- Dust cap available
- Padlockable version available
- For different colours contact Essentra

### PRODUCT CODE

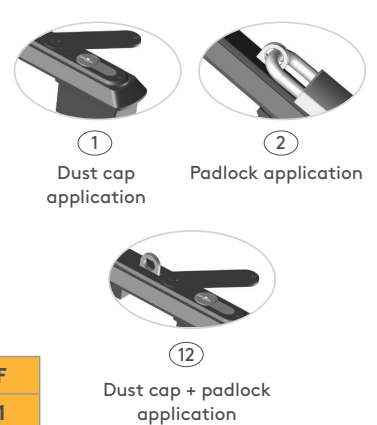
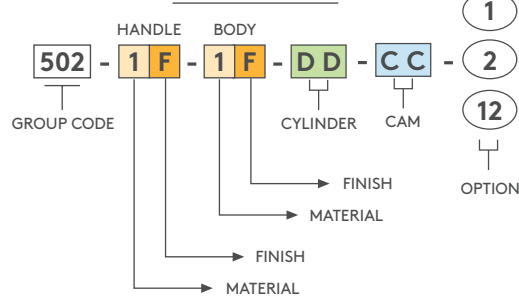

### APPLICATIONS

Electric panels, outdoor cabinets

### MATERIAL

**BODY:** Zamak DIN-EN 1774-ZnAl4Cu1  
**HANDLE:** Zamak DIN-EN 1774-ZnAl4Cu1  
**MECHANISM:** Zamak DIN-EN 1774-ZnAl4Cu1  
**SEAL:** Polyurethane

MATERIAL	M	FINISH	F
Zamak	1	Chrome	1
		Black coated	2

ZAMAK CYLINDER	DD
Stainless steel dust cap (Keyed alike)	03
Stainless steel dust cap (Keyed differ)	32
CH751 (Stainless steel dust cap)	07

BRASS CYLINDER	DD
No cylinder	00
Keyed alike	11

HIGH-SECURITY CYLINDER			
Brass cylinder		Zamak cylinder	
Keyed alike	Keyed differ	Keyed alike	Keyed differ
20	21	22	23

- For cams please check pages: 146 - 147
- For rods please check pages: 150 - 161
- For keys please check pages: 162 - 163